

Sold

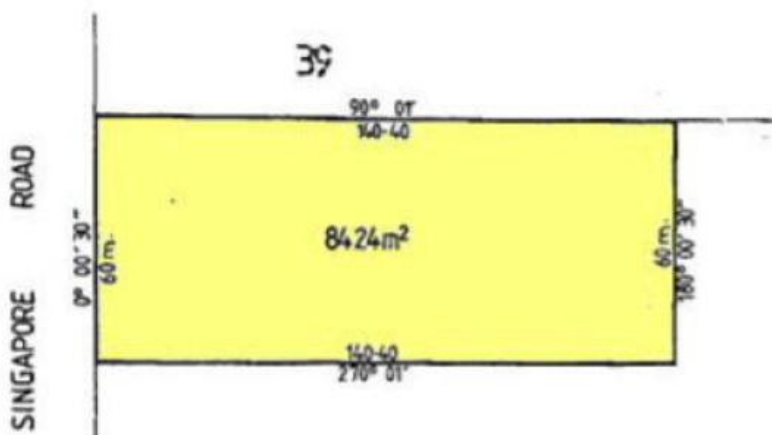

DEPTH LIMITATION: 15.24m

CERTIFICATION BY SURVEYOR

I certify that this plan has been made by me or under my immediate supervision and accords with title.

LICENCED SURVEYOR

DATED: 18/6/09

PLAN APPROVED 18-6-

(ASSISTANT) REGISTRAR OF TITLES

THE LAND TO BE CONSOLIDATED IS SHOWN ENCL. BY CONTINUOUS THICK LINES

TITLE REF: E 9479 F.783 & E 9479 F.945

LAST PLAN REF: LP 140650

PLAN OF CONSOLIDATION

COUNTY: MORIA C.S. 835

PARISH: YARROWEYAH

SECTION 5

CROWN ALLOTMENT 40 (PART)

367 Singapore Road, Yarroweyah

SEAL AND ENDORSEMENT OF MUNICIPALITY

MUNICIPALITY SHIRE OF COBRAM COUNCIL REF.

Sealed Pursuant to the provisions of Sec. 960 A & B of the Land Act, 1962

Two Acre Block with Planning Permit

Great new home site available on Singapore Road. Approximately two acres with large open bay shed. Plenty of established trees. Two entrances including a gravelled drive. Current planning permit included. Power at boundary and 1 meg water.

The above information provided has been furnished to us by the vendor/s. We have not verified whether or not that information is accurate and do not have any belief in one way or the other in its accuracy. We do not accept any responsibility to any person for its accuracy and do no more than pass it on. All interested parties should make and rely upon their own inquiries in order to determine whether or not this information is in fact accurate.

8,424 m²

Price SOLD for \$87,000
Property Type Residential
Property ID 1315
Land Area 8,424 m²

Agent Details

Andrew Jenkins - 0428 570 717

Office Details

Cobram
 33 High Street Cobram VIC 3644
 Australia
 03 5871 1025



ANDREW JENKINS
 REAL ESTATE